

CAMPANELLA TIPO

Connessione alle catene con le maglie tipo G

Codice	Portata*	PER CATENE MM		DIMENSIONI IN mm			Peso Kg.
		1 Br.	2 Br.	L	B	D	
O06-8	1.25	6	—	100	60	11	0.2
O08-8	2.5	7.8	6	120	70	14	0.4
O108-8	4.0	10	7.8	140	80	17	0.7
O13-8	6.3	—	—	150	90	19	1.0
O1310-8	8.0	13	10	160	95	22	1.5
O16-8	11.5	—	—	190	110	25	2.2
O1613-8	15.0	16	13	180	105	28	2.7
O19-8	17.0	—	—	200	120	30	3.5
O2216-8	20.0	19.22	16	240	140	34	5.1
O26-8	25.0	—	—	250	150	38	7
O2619-8	30.0	26	19	250	150	40	8
O3222-8	37.0	32	22	300	180	45	12

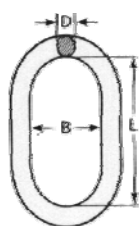

CATENE TIPO GR80

GRADO 8

Codice	Portata*	DIMENSIONI IN mm			Peso Kg.
		D	E	H	
GR80-7	1.5	7	21	10	1.1
GR80-8	2.0	8	24	11	1.4
GR80-10	3.2	10	30	14	2.2
GR80-13	5.4	13	39	18	3.7
GR80-16	8.0	16	48	22	5.6

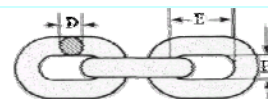

MAGLIE TIPO G

DI GIUNZIONE disponibili anche nella versione anti-manomissione

Codice	Portata*	Per catene di mm.	DIMENSIONI IN mm				Peso Kg.
			L	B	G	E	
G-06-8	1.12	6	44	15	7	17	0.1
G-7/8-8	2.0	7.8	56	18	9	22	0.2
G-10-8	3.2	10	68	25	12	26	0.3
G-13-8	5.4	13	88	29	15	33	0.7
G-16-8	8.0	16	104	36	19	40	1.1

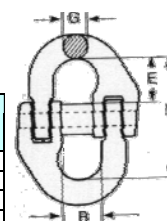

CAMPANELLA TIPO MT

Connessione alle catene e funi con le maglie tipo G

Codice	Portata* Max (m) 0-45 0-90	DIMENSIONI IN mm.								Peso Kg.
		L1	L	B	D	l	b	d		
MT6-8	3.5	270	150	90	19	120	70	14	1.8	
MT8-8	5	300	160	95	22	140	80	17	3.1	
MT10-8	11.5	360	200	120	30	160	95	22	6.5	
MT13-8	17	450	250	150	40	200	120	30	15	
MT16-8	28	500	300	200	50	200	120	32	23	
MT19-8	35	550	300	200	55	250	150	38	33	
MT22-8	53	610	350	200	60	260	150	45	46	
MT26-8	70	730	450	250	70	280	160	50	71	
MT32-8	90	750	470	260	80	280	160	55	91	

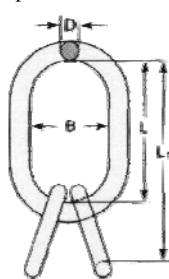

GANCIO TIPO BL DI SICUREZZA

Codice	Portata*	Per catene di mm	DIMENSIONI IN mm			Peso Kg.
			L	B	G	
BL-06-8	1.12	6	27	20	9	0.11
BL-7/8-8	2.0	7.8	35	25	11	0.14
BL-10-8	3.2	10	45	32	14	0.3
BL-13-8	5.4	13	56	40	17	0.7
BL-16-8	8.0	16	68	50	22	1.2

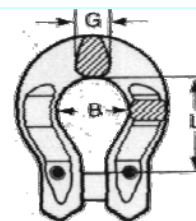

GANCIO TIPO BK DI SICUREZZA

Codice	Portata*	Per catene di mm	DIMENSIONI IN mm						Peso Kg.
			L	B	E	F	G	H	
BK-7/8-8	2.0	7.8	137	26	25	11	17	23	0.7
BK-10-8	3.2	10	168	44	32	13	25	29	1.5
BK-13-8	5.4	13	208	54	40	16	28	38	2.7
BK-16-8	8.0	16	254	63	50	20	37	49	5.6

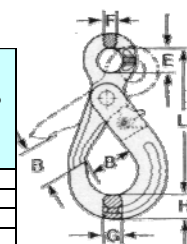

CAMPANELLA TIPO MF

Connessione alla catena con Berglok e maglie tipo G

Codice	Port*	PER CATENE		DIMEN IN mm			Peso Kg.
		DI mm. 3 o 4 Br.		L	B	D	
		1 Br.	2 Br.				
MF6-8	1.25	6	—	100	60	11	0.2
MF8-8	2.5	7.8	6	120	70	14	0.4
MF108-8	4.0	10	7.8	140	80	17	0.8
MF1310-8	7.5	13	10	160	95	22	1.5
MF1613-8	10	16	13	190	105	25	2.73
MF2016-8	17.0	19	16	240	140	34	5.3
MF2220-8	25.0	—	19	250	150	38	7

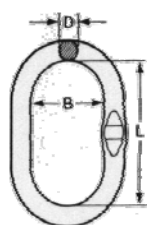

GANCIO TIPO OBK DI SICUREZZA

Codice	Portata*	PER CATENE DI mm. 3 o 4 Br.	DIMENSIONI IN mm						Peso Kg.
			L	B	E	F	G	H	
OBK-7/8-8	2.0	7.8	129	34	25	10	17	20	0.7
OBK-10-8	3.2	10	162	42	32	13	21	26	1.2
OBK-13-8	5.4	13	195	50	40	15	26	30	2.0
OBK-16-8	8.0	16	237	60	50	19	30	38	4.1

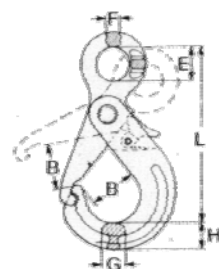

CAMPANELLA TIPO OTF

Connessione alla catena con Berglok e maglie tipo G

Codice	Portata*	PER CATENE DI mm. 3 o 4 Br.	DIMENSIONI IN mm.						Peso Kg.	
			L1	L	B	D	l	b		d
OTF6-8	5.0	6	260	150	90	19	110	60	14	1.8
OTF8-8	8.0	7.8	300	160	95	22	140	80	17	2.8
OTF10-8	16.0	10	360	200	120	30	160	95	22	6
OTF13-8	30.0	13	430	250	150	40	180	105	28	13
OTF16-8	40.0	16	500	300	200	50	200	110	32	23
OTF19-8	50.0	19	560	300	200	55	260	140	38	32

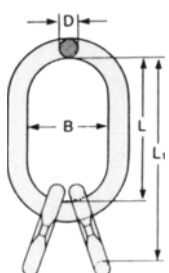

*Coefficiente di sicurezza 4:1

GANCIO TIPO EKN CON LINGUETTA

Codice	Portata*	PER CATENE DI mm. 3 o 4 Br.	DIMENSIONI IN mm						Peso Kg.
			L	B	E	F	G	H	
EKN5/6-8	1.12	6	94	24	22	10	16	19	0.3
EKN7/8-8	2.0	7.8	105	28	25	11.5	17	22	0.5
EKN10-8	3.15	10	131	37	32	13.5	19	29	0.9
EKN13-8	5.3	13	161	42	40	17.5	27	36	1.8
EKN16-8	8.0	16	197	52	50	22	34	44	3.4
EKN18/20-8-8	12.5	19	229	60	60	26	37	52	5.1
EKN22-8	15.0	22	267	77	64	31	42	67	8.9

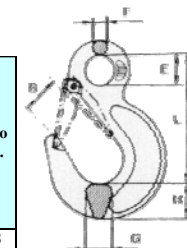

GANCIO TIPO GBK DI SICUREZZA CON SICURA AD INCASTRO

Codice	Portata* PER CATENE DI mm. 3,0-4 Br.	DIMENSIONI IN mm				Peso Kg.	
		L	B	G	H		
GBK-7/8-8	2.0	7.8	112	34	17	20	0.6
GBK-10-8	3.2	10	137	42	21	24	1.1
GBK-13-8	5.4	13	167	50	26	30	2.0
GBK-16-8	8.0	16	198	60	30	38	4.2

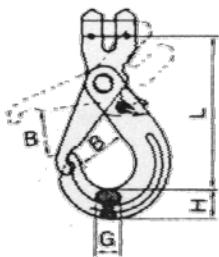

LINGUETTE DI SICUREZZA PER GANCI EKN-EGKN

* KIT CON MOLLA E PERNO

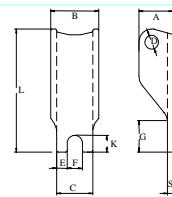

Codice	Per ganci	B	L	C	E	F	A	K	S	G	D
SEK78	2	23	55	17	4.5	6	15	6	3	8	5.5
SEK108	3.2	27.5	70	19	6	8	18	9	4	11	6.5
SEK138	5.4	33.5	80	24	7	10	23	11	4	15	8.5
SEK168	8.0										

GANCIO TIPO BKG DI SICUREZZA

Codice	Portata* PER CATENE DI mm. 3,0-4 Br.	DIMENSIONI IN mm				Peso Kg.	
		L	B	G	H		
BKG-7/8-8	2.0	7.8	119	36	17	23	0.8
BKG-10-8	3.2	10	142	44	25	29	1.5
BKG-13-8	5.4	13	180	54	28	38	2.8
BKG-16-8	8.0	16	216	63	37	49	5.1

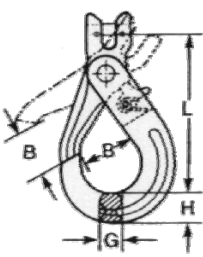

LINGUETTE DI SICUREZZA PER GANCI GOA-GSC

* KIT CON MOLLA E PERNO

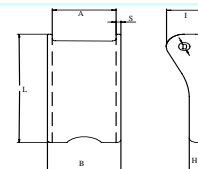

Codice	Per ganci Portata *	A	B	L	S	H	I	D
SI250	0.75-1-1.5	12	16.3	40	2	6	14.5	4.5
S2000	2	18	22.5	44	2	7	16.2	4.5
S2532	2.5-3.2	20	24.5	50	2	7.5	17	4.5
S5400	5.4	22	34	79	3	9	23.5	5.5
S8000	7.5-8	29	35	80	3	9	23.5	7

GANCIO TIPO EGKN PER BRAGHE CON LINGUETTA

Codice	Portata* PER CATENE DI mm. 3,0-4 Br.	DIMENSIONI IN mm				Peso Kg.	
		L	B	G	H		
GKN-7/8-8	2.0	7.8	96	27	18	22	0.5
GKN-10-8	3.2	10	121	34	23	29	1.0
GKN-13-8	5.4	13	147	42	28	36	2.1
GKN-16-8	8.0	16	170	49	33	43	3.6

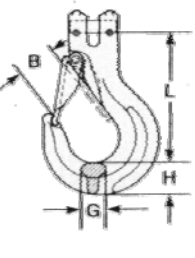

GANCI DI SOLLEVAMENTO AD ALTA RESISTENZA

In acciaio legato - bonificato - verniciati

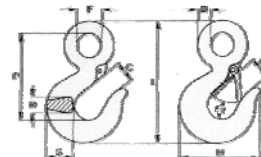

Codice	GOA1250	GOA1600	GOA2500	GOA3200	GOA5400	GOA8000
Port.	1.25	1.6	2.5	3.	5.4	8.0
C	23	26	26	30	34	55
CI	21	23	23	26	30	51
D	90	110	115	145	175	230
F	19	23	28	30	38	51
FI	17	17	25	30	35	45
H	67	75	87	96	117	170
L	110	125	141	162	200	277
P	82	93	104	119	146	203
R	14	16	19	21	29	38
S	21	25	31	35	44	60
Peso Kg.	0.3	0.36	0.6	0.95	1.7	3.4

* portata in tonnellate coefficiente di sicurezza

GANCIO TIPO GG BLOCCAMAGLIA

Codice	Portata* PER CATENE DI mm. 3,0-4 Br.	DIMENSIONI IN mm		Peso Kg.	
		L	B		
GG-7-8	1.5	7	56	10	0.3
GG-10-8	3.2	10	78	13	0.8
GG-13-8	5.4	13	97	16	1.5
GG-16-8	8.0	16	124	20	2.8

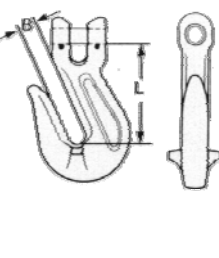

GANCIO TIPO OG BLOCCAMAGLIA

Codice	Portata* PER CATENE DI mm. 3,0-4 Br.	DIMENSIONI IN mm				Peso Kg.	
		L	B	E	F		
OG-7-8	1.5	7	60	10	15	9	0.2
OG-8-8	2.0	8	70	11	16	10	0.4
OG-10-8	3.2	10	84	13	20	12	0.6
OG-13-8	5.4	13	104	16	25	15	1.2
OG-16-8	8.0	16	130	20	28	19	2.4

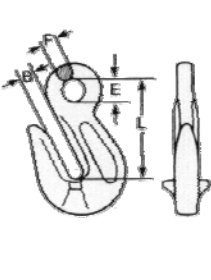

GANCI GIREVOLI

In Acciaio al carbonio bonificati verniciati

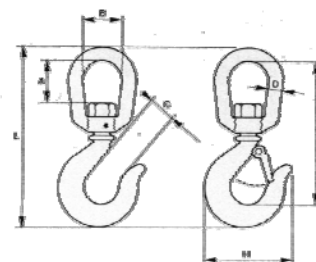

Codice	GSC750	GSC1000	GSC1600	GSC2000	GSC3200	GSC5000	GSC7500
Port.	0.75	1.0	1.5	2.0	3.0	5.0	7.5
A	27	36	48	43	57	73	74
B	31	40	45	45	61	75	87
C	20	22	24	25	30	42	50
D	10.0	13.5	17.5	18.0	22.0	27.0	30.0
H	72	80	89	104	126	165	196
L	146	184	208	221	277	341	404
P	117	149	164	173	215	267	315
Peso Kg.	0.41	0.885	1.3	1.615	3.4	5.95	10.3

* portata in tonnellate coefficiente di sicurezza 5

GRILLI A OMEGA AD ALTA RESISTENZA

In Acciaio legato - Zincati

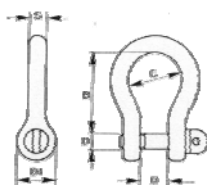

Codice	Portata*	D	B	C	D1	H	S	Peso Kg
G01	1.00	11	36	26	22	16	10	0.14
G01,5	1.50	13	43	29	25	18.5	11	0.21
G02	2.00	16	51	32	32	22	13	0.34
G0325	3.25	19	64	43	38	26	16	0.63
G0475	4.75	22	76	51	44	31	19	0.95
G065	6.50	25	83	58	50	36	22	1.55
G085	8.50	28	95	68	56	43	25	2.30
G095	9.50	32	108	75	64	47	28	3.24
G012	12.0	35	115	83	70	51	32	4.40
G013.5	13.5	38	133	92	84	57	35	5.93
G017	17.0	42	146	99	84	60	38	7.50
G025	25.0	50	178	126	100	74	45	14.0

* portata in tonnellate coefficiente di sicurezza 5

GRILLI DIRITTI UNI 1947 Tipo A

Forgiati - Zincati

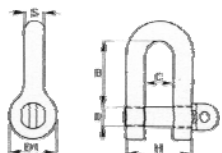

Codice	Portata*	D	B	C	D1	H	S	Peso Kg
G5	90	5	23	10	10	20	5	18
G6	140	6	30	13	13	26	6	30
G8	250	8	34	17	17	34	8	70
G10	380	10	41	19	20	40	10	127
G12	630	12	42	20	26	40	12	190
G14	800	14	46	22	29	44	13	250
G16	1000	16	50	24	32	48	14	320
G18	1250	18	54	26	35	53	15.5	430
G20	1600	20	58	28	38	58	17	590
G22	2000	22	69	32	44	68	20	930
G25	2500	25	79	36	50	78	23	1400

* portata in tonnellate coefficiente di sicurezza 5

GOLFARI FEMMINA DIN 582

Zincati

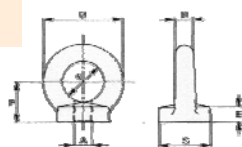

Codice	Portata*	A	D	E	F	H	P	S
GZF6	75	M6x1	8	6	20	36	18	14
GZF8	140	M8x1.25	8	6	20	36	18	20
GZF10	230	M10x1.5	10	8	25	45	23	25
GZF12	340	M12x1.75	12	10	30	54	28	30
GZF14	460	M14x2	12	10	30	54	28	30
GZF16	700	M16x2	14	12	35	63	28	35
GZF18	850	M18x2.5	14	12	35	63	33	35
GZF20	1200	M20x2.5	16	14	40	72	33	40
GZF22	1500	M22x2.5	16	14	40	72	38	40
GZF24	1800	M24x3	20	18	50	90	38	50
GZF27	2700	M27x3	21	20	50	90	50	55
GZF30	3600	M30x3.5	24	22	60	108	59	65
GZF36	5100	M36x4	28	26	70	126	69	75
GZF42	7000	M42x4.5	32	30	80	144	75	85
GZF48	8600	M48x5	38	35	90	165	85	100
GZF363	5100	M36x3	28	26	70	126	69	75
GZF423	7000	M42x3	32	30	80	144	75	85
GZF483	8600	M48x3	38	35	90	165	85	100

* portata in kg coefficiente di sicurezza 5

GOLFARI MASCHI DIN 580

In Acciaio al carbonio bonificati verniciati

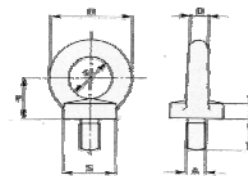

Codice	Portata*	A	D	E	F	H	P	R	S
GZM6	75	M6x1	8	15	20	36	18	6	20
GZM8	140	M8x1.25	8	15	20	36	18	6	20
GZM10	230	M10x1.5	10	18	25	45	23	8	25
GZM12	340	M12x1.75	12	22	30	54	28	10	30
GZM14	460	M14x2	12	22	30	54	28	10	30
GZM16	700	M16x2	14	28	35	63	28	12	35
GZM18	850	M18x2.5	14	28	35	63	33	12	35
GZM20	1200	M20x2.5	16	30	40	72	33	14	40
GZM22	1500	M22x2.5	16	30	40	72	38	14	40
GZM24	1800	M24x3	20	38	50	90	38	18	50
GZM27	2700	M27x3	24	45	60	108	48	22	65
GZM30	3600	M30x3.5	24	45	60	108	59	22	65
GZM33	4300	M33x3.5	28	55	70	126	69	26	75
GZM36	5100	M36x4	28	55	70	126	69	26	75
GZM42	7000	M42x4.5	32	63	80	144	75	30	85
GZM48	8600	M48x5	38	68	90	165	85	35	100
GZM332	4300	M33x2	28	55	70	126	69	26	75
GZM363	5100	M36x3	28	55	70	126	69	26	75
GZM423	7000	M42x3	32	63	80	144	75	30	85
GZM483	8600	M48x3	38	68	90	165	85	35	100

* portata in kg coefficiente di sicurezza 5

MORSETTI IN ACCIAIO

Per funi - Zincati

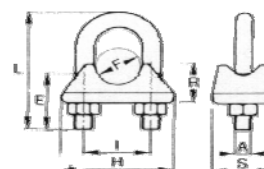

Codice	F **	A	E	H	I	L	R	S	Peso Kg
M3	1/8	M4	12	18	9	20	7	10	9
M5	3/16	M5	13	24	13	24	10	15	20
M6	1/4	M6	15	27	15	28	11	16	33
M8	5/16	M6	19	31	17	34	12	18	40
M10	3/8	M8	22	37	20	42	13	21	80
M11	7/16	M8	22	41	22	44	14	24	79
M13	1/2	M10	33	44	25	55	15	26	130
M14	9/16	M10	33	44	25	55	15	26	130
M16	5/8	M10	33	51	29	63	20	28	175
M18	11/16	M12	44	56	34	75	21	32	260
M20	3/4	M12	44	6	34	75	22	33	290
M22	7/8	M12	52	65	39	85	25	35	340
M26	1"	M14	50	72	42	95	27	40	490
M30	1" 1/8	M14	50	78	47	110	33	43	620
M34	1" 1/4	M16	55	88	53	120	37	48	840
M40	1" 1/2	M16	60	98	59	140	40	54	1120

RADANCE TIPO LEGGERO

Zincate * portata in kg

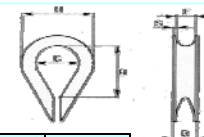

Codice	F	B	C	H	R	S	Peso Kg
R1	2	14	9.5	14	5.0	0.5	1.2
R3	3	18	9.5	16	5.5	0.6	2.5
R4	4	19	11.5	18	6.5	0.7	3.0
R5	5	24	14.0	22	7.5	0.8	5.0
R6	6	28	17.0	26	9.0	1.0	8.0
R8	8	33	19.0	30	12.0	1.2	15.0
R10	10	38	21.5	34	14.5	1.5	23.0
R12	12	47	30.0	46	16.0	2.0	43.0
R14	14	54	33.0	50	18.5	2.2	62.0
R16	16	57	37.5	57	21.0	2.2	85.0
R18	18	68	46.0	69	24.0	2.5	135.0
R20	20	78	51.0	78	27.0	3.0	215.0
R22	22	88	56.0	82	27.0	3.0	230.0
R25	25	94	60.0	91	31.0	3.5	330.0
R28	28	115	74.0	112	39.0	4.0	585.0

TENDITORE A 2 OCCHI

Zincati

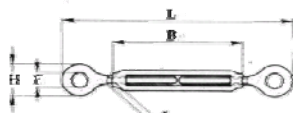

* portata in kg

Codice	Port*	A	B	F	H	L min	L max	Peso Kg
TOO5	70	M5	78	8	16	110	170	41
TOO6	140	M6	88	10	20	128	196	58
TOO8	240	M8	105	11	22	158	239	109
TOO10	360	M10	125	14	28	192	289	195
TOO11	500	M11	135	15	30	206	309	267
TOO12	600	M12	140	17	33	218	324	325
TOO14	900	M14	170	18	35	258	388	520
TOO16	1100	M16	190	25	49	306	450	820
TOO18	1500	M18	205	27	56	338	491	1260
TOO20	1640	M20	220	28	59	358	522	1530
TOO22	2240	M22	240	34	70	400	578	2220
TOO24	2640	M24	260	36	76	436	628	2740
TOO27	3460	M27	300	38	82	504	730	4770
TOO33	4600	M33	300	41	89	516	732	5880

ANELLI TENDITORI

Zincati

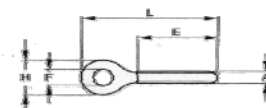

Codice	Port*	A	E	F	H	L	Peso Kg
AT5	70	M5	39	8	16	55	7
AT6	140	M6	44	10	20	64	13
AT8	240	M8	53	11	22	79	27
AT10	360	M10	63	14	28	95	52
AT11	500	M11	68	15	30	103	71
AT12	600	M12	70	17	33	109	90
AT14	900	M14	85	18	35	129	135
AT16	1100	M16	95	25	49	153	240
AT18	1500	M18	103	27	56	169	400
AT20	1640	M20	110	28	59	179	440
AT22	2240	M22	120	34	70	200	670
AT24	2640	M24	130	36	76	218	850
AT27	3460	M27	150	38	82	252	1310
AT33	4600	M33	150	41	89	258	1690

* portata in kg

TENDITORE AD OCCHIO e GANCIO

Zincati

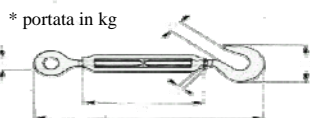

* portata in kg

Codice	Port*	A	B	C	F	H	L min	L max	Peso Kg
TOG5	50	M5	78	6.5	8	17	117	177	43
TOG6	70	M6	88	8.5	10	22	132	200	60
TOG8	130	M8	105	10.0	11	30	169	250	114
TOG10	200	M10	125	12.5	14	35	202	299	210
TOG11	250	M11	135	13.0	15	36	215	318	275
TOG12	300	M12	140	17.5	17	56	240	346	400
TOG14	430	M14	170	21.0	18	66	285	415	650
TOG16	540	M16	190	24.0	25	77	330	474	1010
TOG18	800	M18	205	27.0	27	85	363	516	1390
TOG20	1200	M20	220	30.0	28	95	391	555	1840
TOG22	1700	M22	240	34.0	34	106	433	611	2580
TOG24	2000	M24	260	36.0	36	114	470	662	3450

GANCI PER TENDITORI

Zincati

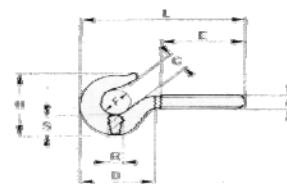

Codice	Port*	A	C	D	E	F	H	L	R	S
GT5	50	M5	6.5	20	39	7.5	17	62	4.0	4.5
GT6	70	M6	8.5	23	44	9.5	22	68	5.0	5.5
GT8	130	M8	10.0	35	53	11	30	90	6.0	8.0
GT10	200	M10	12.5	43	63	14	35	106	8.0	9.5
GT11	250	M11	13.0	44	68	14	36	112	9.0	10.5
GT12	300	M12	17.5	58	70	23	56	131	12.2	18.5
GT14	430	M14	21.0	68	85	27	66	156	14.3	21.5
GT16	540	M16	24.0	79	95	31	77	177	16.5	25.0
GT18	800	M18	27.0	87	103	35	85	194	18.5	27.5
GT20	1200	M20	30.0	98	110	39	95	212	20.7	31.0
GT22	1700	M22	34.0	109	120	43	106	233	23.0	34.5
GT24	2000	M24	36.0	118	130	47	114	252	25.0	37.5

TENDITORE A 2 GANCI

Zincati

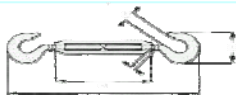

* portata in kg

Codice	Port*	A	B	C	H	L min	L max	Peso Kg
TGG5	50	M5	78	6.5	17	124	184	45
TGG6	70	M6	88	8.5	22	136	204	62
TGG8	130	M8	105	10.0	30	180	261	110
TGG10	200	M10	125	12.5	35	212	309	220
TGG11	250	M11	135	13.0	36	224	327	285
TGG12	300	M12	140	17.5	56	262	368	475
TGG14	430	M14	170	21.0	66	312	442	780
TGG16	540	M16	190	24.0	77	354	498	1200
TGG18	800	M18	205	27.0	85	388	541	1520
TGG20	1200	M20	220	30.0	95	424	588	2150
TGG22	1700	M22	240	34.0	106	466	644	2820
TGG24	2000	M24	260	36.0	114	504	696	4160

MOSCHETTONI IN ACCIAIO

Zincati

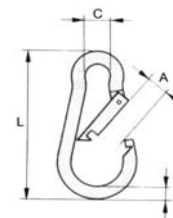

Codice	Portata Kg	L	C	A	B
MOSC-5	30	50	6	7	5
MOSC-6	40	60	7	8	6
MOSC-8	75	80	9.5	10.5	8
MOSC-10	120	100	12	13	10
MOSC-12	140	140	14.5	18	12

TENDITORE A 2 TRONCHI

Zincati

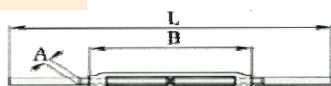

Codice	Port*	A	B	L min	L max	PesoKg
TTT5	160	M5	78	160	220	47
TTT6	220	M6	88	180	248	62
TTT8	390	M8	105	210	292	120
TTT10	670	M10	125	250	347	210
TTT11	800	M11	135	270	374	305
TTT12	970	M12	140	280	386	345
TTT14	1300	M14	170	340	470	580
TTT16	1750	M16	190	380	525	740
TTT18	2200	M18	205	410	564	1100
TTT20	2700	M20	220	440	604	1530
TTT22	3400	M22	240	480	659	2280
TTT24	4100	M24	260	520	712	2560
TTT27	5200	M27	300	590	816	4330
TTT33	6400	M33	300	600	816	5700

* portata in kg

TIRANTE AD OCCHIO

UNI 6058

d	l		d1 mm	d2 mm	a mm
M8	50	65	16	6	9
M10	80	130	20	8	12
M12	95	125	24	10	14
M14	110		28	12	16
M16	130		32	14	18
M18	150		36	16	20
M20	160		40	18	2
M22	180		44	18	24
M24	200		48	20	26
M27	220		54	22	30
M30	230		60	25	33

Esempio Ordine: 6058M850

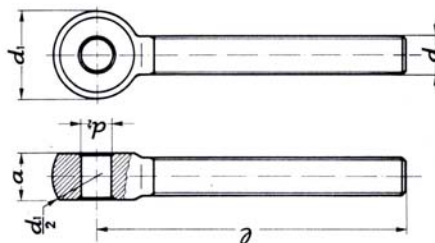

FUNE ACCIAIO ZINCATO IMPIEGHI COMMERCIALI

Res. Fili 1570 N/mm² (160 kgf/mm²)

Codice	Diam. Fune mm	Peso per 100 m Kg.	Carico rottura minimo		Diametro fili esterni mm
			kgf	daN	
M102	2	1.5	245	240	0.28
M103	3	3.0	430	422	0.33
M104	4	4.2	660	647	0.33
M105	5	6.0	835	819	0.33
M106	6	9.0	1200	1177	0.40
M108	8	16.0	2140	2100	0.53
M110	10	25.1	3340	3280	0.66
M112	12	36.1	4810	4720	0.80
M114	14	49.1	6550	6430	0.93

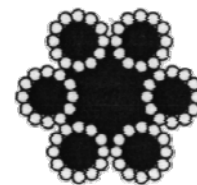

72 fili (6x12)
7 anime tessili crociata destra
28 fili (4x7) 36 fili (6x6)
54 fili(6x9)

FUNE ACCIAIO LUCIDO CLASSE 222 FILI

Res. Fili 1770 N/mm² (180 kgf/mm²)

Codice	Diam. Fune mm	Peso per 100 m Kg.	Carico rottura minimo		Diametro fili esterni mm
			kgf	daN	
S1010CD	10	43	7050	6910	0.57
S1012CD	12	61	10150	9950	0.69
S1014CD	14	83	13810	13540	0.80
S1016CD	16	109	18040	17690	0.91
S1018CD	18	138	22830	22390	1.03
S1020CD	20	170	28180	27640	1.14
S1022CD	22	206	34090	33440	1.26
S1024CD	24	245	40580	39800	1.37
S906CD	6	15	2460	2410	0.31
S908CD	8	27	4370	4280	0.41

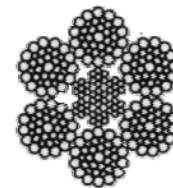

216 fili (6x12)
WARRINGTON
SEALE+WR crociata destra
Crociata sinistra UNI ISO 2408

FUNE ACCIAIO LUCIDO ANTIGIREVOLE

Res. Fili 1960 N/mm² (180 kgf/mm²)

Codice	Diam. Fune mm	Peso per 100 m Kg.	Carico rottura minimo		Diametro fili esterni mm
			kgf	daN	
FAZA44	4	6.4	1230	1148	0.26
FAZA45	5	10.0	1830	1795	0.32
FAZA46	6	14.3	2640	2590	0.38
FAZA47	7	19.5	3600	3530	0.44
FAZA48	8	25.5	4700	4610	0.51
FAZA49	9	32.3	5950	5840	0.57
FAZA410	10	39.8	7340	7200	0.63
FAZA411	11	48.2	8880	8710	0.70
FAZA412	12	57.5	10570	10370	0.76
FAZA4125	12.5	62.4	11470	11250	0.79
FAZA414	14	78.0	14400	14130	0.88
FAZA416	16	102.0	18800	18440	1.01

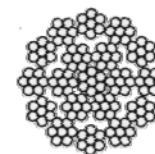

216 fili (6x12)
WARRINGTON
SEALE+WR crociata destra
Crociata sinistra UNI ISO 2408

ALTRI TIPI DI FUNI DISPONIBILI A RICHIESTA

Coefficiente di sicurezza delle funi metalliche		
Tipo di apparecchio	Norma Vigente	Coefficiente di sicurezza (riferito al carico statico)
Gru, argani, paranchi, apparecchi di trazione	Art. 179 DPR	6
	547-55	5
Argani di edilizia	Art. 58 DPR 164-56	8
Ascensori	Art. DPR. 1497-63	12



FASCE PIATTE IN POLIESTERE A DOPPIO NASTRO

Con asole rinforzate a norme EN 1492-1



Esempio Ordin: FASCIA90x3000
Cod. ORD.: 77814030

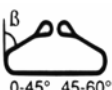
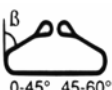

Colore che identifica la portata	Codice da riportare insieme alla lunghezza	Lunghezza indicativa mm	Portata					Lunghezza minima mm
								
Viola	77812	30	1	0,8	2	1,4	1	1000
Verde	77813	60	2	1,6	4	2,8	2	1000
Giallo	77814	90	3	2,4	6	4,2	3	2000
Grigio	77815	120	4	3,2	8	5,6	4	2000
Rosso	77816	150	5	4,0	10	7,0	5	2000
Marrone	77817	180	6	4,8	12	8,4	6	2000
Blu	77818	240	8	6,4	16	11,2	8	2000
Arancio	77819	300	10	8,0	20	14,0	10	2000

LUNGHEZZE STANDARD FINO A 10 mt
OLTRE SU RICHIESTA

CORDA NYLON

Codice	Descrizione	Car.Rottura
CN4	Corda nylon Ø 4	Kg 250
CN6	Corda nylon Ø 6	Kg 500
CN8	Corda nylon Ø 8	Kg 850
CN10	Corda nylon Ø 10	Kg 1200
CN12	Corda nylon Ø 12	Kg 1900
CN14	Corda nylon Ø 14	Kg 2200
CN16	Corda nylon Ø 16	Kg 2800
<i>Altre misure su richiesta.</i>		

Corda in nylon, filato di poliestere semilucido.
Anima in poliestere.
Per industrie, ferramenta, edilizia, pesca e nautica.

