

NIPLO MASCHIO DOPPIO MATERIALE INOX 304

COD.	F	D1	CH
3230418	1/8	28	14
3230414	1/4	30	17
3230438	3/8	32	19
3230412	1/2	35	24
3230434	3/4	40	30
0323041	1	45	36
32304114	1-1/4	50	46
32304112	1-1/2	55	50
0323042	2	60	65
32304212	2-1/2	70	80
0323043	3	82	95
32304312	3-1/2	88	110
0323044	4	92	120

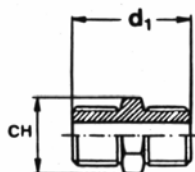

GOMITO 90° F/F MATERIALE INOX 304

COD.	F	L	H	A	i	B
3430418	1/8	25	15	14	18	10
3430414	1/4	30	20	18	20	10
3430438	3/8	35	25	23	23	10
3430412	1/2	40	30	28	28	10
3430434	3/4	50	35	33	32	13
343041	1	55	42	40	33	15
34304114	1-1/4	70	50	48	45	20
34304112	1-1/2	75	60	60	48	20
343042	2	90	70	69	55	20

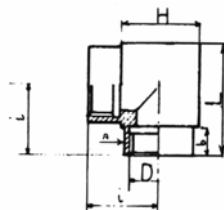

RACCORDO A T FEMMINA MATERIALE INOX 316

COD.	F	D1	D2
7531618	1/8	35.2	17.6
7531614	1/4	38.0	19.0
7531638	3/8	47.0	23.5
7531612	1/2	58.0	29.0
7531634	3/4	65.0	32.5
753161	1	75.0	37.5
75316114	1-1/4	89.0	44.5
75316112	1-1/2	97.0	48.5
753162	2	118	59.0
75316212	2-1/2	136	68.0
753163	3	161	80.5
753164	4	196	98.0

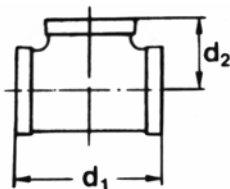

PEZZO A T FEMMINA MATERIALE INOX 314

COD.	F	L	H	A	i	B
3430418	1/8	25	15	14	18	10
3430414	1/4	30	20	18	20	10
3430438	3/8	35	25	23	23	10
3430412	1/2	40	30	28	28	10
3430434	3/4	50	35	33	32	13
343041	1	55	42	40	33	15
34304114	1-1/4	70	50	48	45	20
34304112	1-1/2	75	60	60	48	20
343042	2	90	70	69	55	20

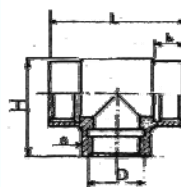

GOMITO A 90° M/F MATERIALE INOX 316

COD.	F	D1	D2
7331618	1/8	17.6	25
7331614	1/4	19.0	30
7331638	3/8	23.5	35
7331612	1/2	29.0	41
7331634	3/4	32.5	48
733161	1	37.5	54
73316114	1-1/4	44.5	62
73316112	1-1/2	48.5	68
733162	2	59.0	83
73316212	2-1/2	68.0	88
733163	3	80.5	115
733164	4	98.0	126

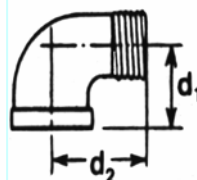

GOMITO A 90° F/F MATERIALE INOX 316

COD.	F	D1
7231618	1/8	17.6
7231614	1/4	19.0
7231638	3/8	23.5
7231612	1/2	29.0
7231634	3/4	32.5
723161	1	37.5
72316114	1-1/4	44.5
72316112	1-1/2	48.5
723162	2	59.0
72316212	2-1/2	68.0
723163	3	80.5
723164	4	98.0

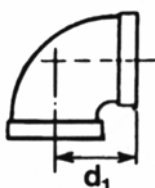

GIUNTO A TRE PEZZI SEDE CONICA MATERIALE INOX 304

COD.	F	D1	CH
3130418	1/8	25	26
3130414	1/4	35	30
3130438	3/8	38	38
3130412	1/2	40	42
3130434	3/4	48	50
313041	1	52	58
31304114	1-1/4	54	68
31304112	1-1/2	60	75
313042	2	63	90
31304212	2-1/2	75	110
313043	3	90	125
313044	4	100	155

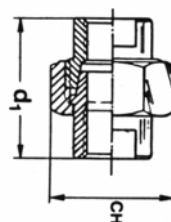

TAPPO FEMMINA

MATERIALE INOX 304

COD.	F	D1	CH
2930418	1/8	12	17
2930414	1/4	14	19
2930438	3/8	16	22
2930412	1/2	17	24
2930434	3/4	19	30
293041	1	22	36
29304114	1-1/4	24	46
29304112	1-1/2	57	55
293042	2	30	65
29304212	2-1/2	40	85
293043	3	45	95
293044	4	50	130

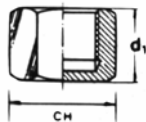

TAPPO MASCHIO

MATERIALE INOX 304

COD.	F	D1	CH
2830418	1/8	17	14
2830414	1/4	19	17
2830438	3/8	21	19
2830412	1/2	24	24
2830434	3/4	26	30
283041	1	29	36
28304114	1-1/4	32	46
28304112	1-1/2	34	50
283042	2	37	65
28304212	2-1/2	54	80
283043	3	60	95
283044	4	72	120

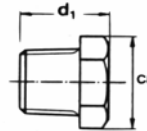

MANICOTTO A SALDARE

MATERIALE INOX 304

COD.	F	D1	D2
2403418	1/8	14	16
2403414	1/4	18	18
2403438	3/8	22	20
2403412	1/2	25.5	25
2403434	3/4	32.5	30
240341	1	39.5	35
24034114	1-1/4	48	38
24034112	1-1/2	55	40
240342	2	70	42
24034212	2-1/2	88	8
240343	3	98	50
24034312	3-1/2	112	55
240344	4	125	60

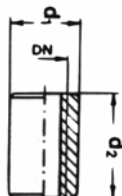

RIDUZIONE M/F

MATERIALE INOX

COD.	F	D1	CH
3031618	1/8	19	17
3031614	1/4	19	17
3031638	3/8	21	19
3031612	1/2	24	24
3031634	3/4	26	30
303161	1	29	36
30316114	1-1/4	32	46
30316112	1-1/2	34	50
303162	2	37	65
30316212	2-1/2	39	80
303163	3	44	95
303164	4	51	120

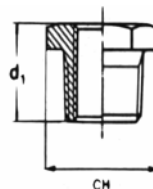

CURVA A SALDARE

MATERIALE INOX 304

COD.	Ø
CSI3/8	3/8
CSI1/2	1/2
CSI3/4	3/4
CSI1	1
CSI11/4	1¼
CSI11/2	1½
CSI2	2
CSI21/2	2½
CSI3	3
CSI31/2	3½
CSI4	4

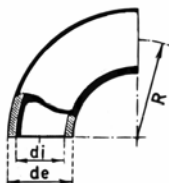

TRONCHETTO A SALDARE

MATERIALE INOX 304

COD.	F	D1	D2
2330418	1/8	20	10.2
2330414	1/4	22	13.7
2330438	3/8	22	17.2
2330412	1/2	25	21.3
2330434	3/4	30	26.9
233041	1	35	33.7
23304114	1-1/4	40	42.4
23304112	1-1/2	45	48.3
233042	2	50	60.3
23304212	2-1/2	50	76.1
233043	3	50	88.9
23304312	3-1/2	50	101.6
233044	4	50	114.3

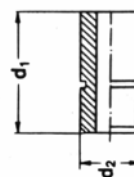

FONDO BOMBATO

MATERIALE INOX 304

COD.	F	Sp
1730412	21.3	2
1730434	26.9	2
173041	33.7	2
17304114	42.4	2
17304112	48.3	2
173042	60.3	2
17304212	76.1	2
173043	88.9	2
173044	114.3	2

