

### VALVOLA DI RITEGNO VERTICALE M/F

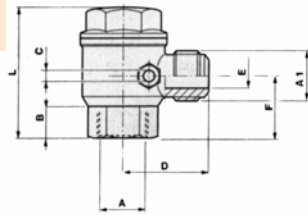

COD.	A	A1	B	C	D	E	F	L
4621238	1/2	3/8	11	6	34	9	22	45.5
4621212	1/2	1/2	12.5	6	38	11	24	54.5
4623434	3/4	3/4	13.5	6	40	14	26	56

### DADO CON SEDE CONICA PER FISSAGGIO TUBO RAME

Codice	A	T	CH
7413/8	3/8	12	19
7411/2	1/2	16	24
7413/4	3/4	18	30
7413/8	3/8	10	19
7411/2	1/2	12	24
7411/2	1/2	14	24
7411/2	1/2	15	24
7413/4	3/4	16	30
7413/4	3/4	20	30

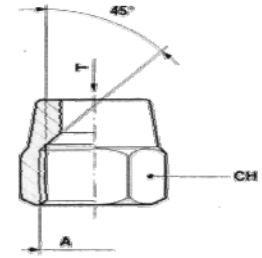

### VALVOLA A CORSOIO

Codice	A	B	L	CH
*	M5	5.5	26.5	8
VFU1/8	1/8	8.5	35.5	13
VFU1/4	1/4	11	42.5	17
VFU3/8	3/8	12	58	24
VFU1/2	1/2	15	64	24

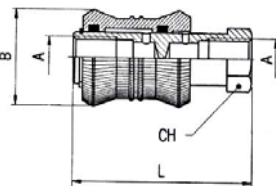

### PASTIGLIA IN NBR

Codice	DIM.
4673/8	3/8
4671/2	1/2
4673/4	3/4

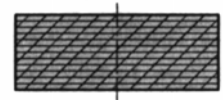

### VALVOLA UNIDIREZIONALE FEMMINA - FEMMINA

Codice	A	B	L	CH
*	1/8	25	48	14
06690713	1/4	30	58	17
06691017	3/8	35	68	22
06691421	1/2	40	80	27

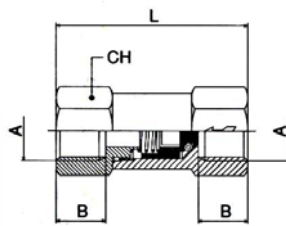

### RUBINETTO SCARICO CONDENSA

Codice	A	B	L	CH
7321/8	1/8	8	31	13
7321/4	1/4	9	27.5	14
7323/8	3/8	9	20	17
7321/2	1/2	8.5	28.5	22

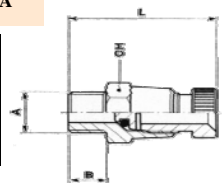

### NIPPO PER FISSAGGIO TUBO RAME

Codice	A	A1	B	B1	L	CH
Q23240	3/8	3/8	14	9	31.5	19
Q25095	1/2	1/2	14	11	34	22
Q25097	3/4	3/4	16	15	42	27

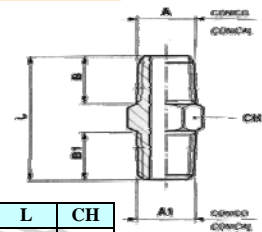

### FILTRO REGOLATORE CON MANOMETRO 2 RUBINETTI ATTACCO A BAIONETTA

Codice	Misura	Conf.
452	3/8	1
454	1/2	1

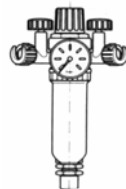

### VALVOLA DI SICUREZZA TARATA E BLOCCATA N ANELLO SCARICO MANUALE A RICHIESTA CON CERTIFICATO

Pressione di max apertura = taratura +10%  
 Temperatura = -10°C + 90°C

Codice	A	B	L	CH	taratura
4601/4	1/4	9	41	18	8
4603/8	3/8	10	55	20	11
4601/2	1/2	10	56	22	11
4603/4	3/4	10	56	22	11
4601	1	10	56	22	11

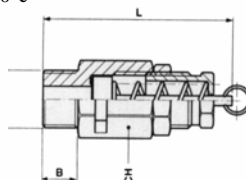

### PRESSOSTATO BIPOLARE E TRIPOLARE A I E 4 VIE CON SCARICO TEST. E PULSANTE

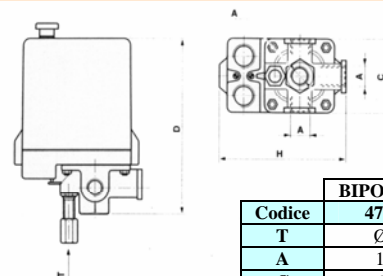

Codice	BIPOLARE	TRIPOLARE
472M	472M	472T
T	Ø 6	Ø 6
A	1/4	1/4
C	51	58
D	115	130
H	80	96

Modello	Bipolare	Tripolare
Vn max (V~)	380	500
In max (A)	30	20
P.Interruz. (KW)	3	4
Pressione regolabile da -a	4 bar / 12 bar	4 bar / 12 bar
Temperatura max	-10/ +50° C	-10/ +50° C
Isteresi	2 bar	2 bar